

RECOMMENDED PCB LAYOUT FOR CONTACT AREA

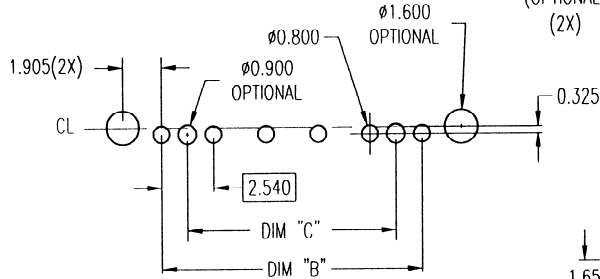

RECOMMENDED PCB LAYOUT FOR SOLDER TAIL SIDE

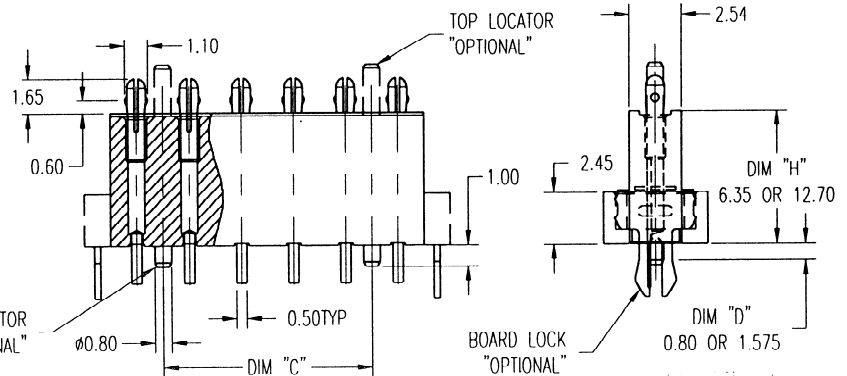
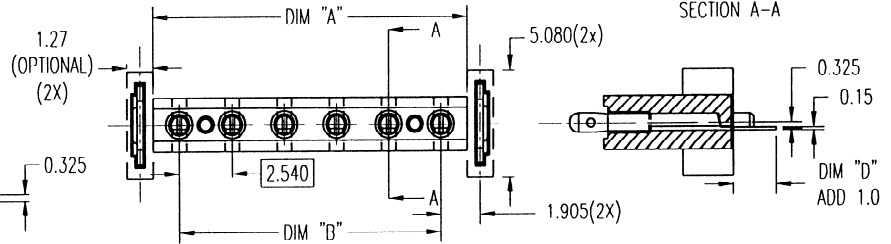
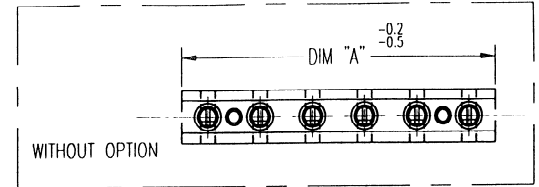

NOTES:

- 1) HOUSING MATERIAL: NYLON 46 30% GF (94V-0) COLOR: BLACK.
- 2) MAXIMUM FLASH ALLOWABLE:  $-0.125$  MAX.
- 3) CAVITY ID AND RANODA LOGO TO ENGRAVE ON EJECTOR PINS. CHARACTER AND EJECTOR TO BE FLUSH OR RECESS INTO THE HOUSING SURFACE.

ALL DIMENSIONS ARE IN MILLIMETRE		REVISIONS										REFERENCE DRAWING		THE INFORMATION HEREIN IS THE PROPERTY OF ANODA ELECTRONICS PTE LTD AND SHALL BE KEPT IN STRICTLY CONFIDENTIAL. IT IS TO BE USED ONLY FOR THE PURPOSES SPECIFIED HEREIN AND IS NOT TO BE REPRODUCED OR TRANSMITTED IN ANY FORM OR BY ANY MEANS, ELECTRONIC OR MECHANICAL, INCLUDING PHOTOCOPYING, RECORDING, OR BY ANY INFORMATION STORAGE AND RETRIEVAL SYSTEM. WITHOUT THE WRITTEN PERMISSION OF ANODA ELECTRONICS PTE LTD.		PART NO. B-AD247-XXXX-XXXX	
CRITICAL		NO.	DESCRIPTION	DATE	DRN	CHK	APPR	ITEM	QTY	DESCRIPTION	PART NO.	REV	DATE	BY	CHK	APPR	SCALE
MAJOR		01	RELEASE FOR MARKETING	04/06/99	THONG	SEAH	SLAH					1	01	2			4:1
SPC		REV	DESCRIPTION	DATE	DRN	CHK	APPR	ITEM	QTY	DESCRIPTION	PART NO.	REV	DATE	BY	CHK	APPR	SCALE

**ANODA ELECTRONICS PTE LTD**  
 45 LOYANG DRIVE SINGAPORE 508954  
 TEL : 54578111 FAX : 5458189

PART NAME: SINGLE ROW HEADER  
 2.54mm PITCH (THRU HOLE)  
 SIZE: A4  
 SHEET: 1 OF 2  
 REV: XX  
 SCALE: 4:1

